

# WINTON BOX GRADER WRB SERIES



**OWNERS MANUAL**

**PLEASE READ THIS MANUAL BEFORE OPERATING THE MACHINE**

Congratulations on purchasing your new **Winton** machine

Before you get started, we have provided a helpful space to jot down a few important details about your new Winton machine.

Model Number: **WRB**

Serial Number:

Date of purchase:

Factory Reference: RB4/4BS, RB5/5BS, RB6/6BS

This manual should be considered a permanent part of this machine and should remain with it even if the machine is subsequently sold.

Winton continually seeks advancements in its product design and quality. Therefore, while this manual contains the most current product information available at the time of printing, there may be minor discrepancies between your machine and this manual.

If you have any questions concerning this manual, please consult your local dealer.

First Published: February 2021

## **General Safety Information**

Ensure all potential operators read this manual thoroughly before using the machine.

**Safety:** Ensure tractor and machine is stopped & keys out of ignition before set-up/maintenance.

**Safety:** Failure to follow good safety standards could result in severe injury or even death.

**Misuse:** This machine is designed for use with compact tractors, and should be used only for the indicated purpose. Winton does not take responsibility if the machine is used for any other purpose. Children must not operate the machine under any circumstance.

**Modification:** Do not modify equipment in any way. This may impair the operation and overall safety of the machine.

**Tractor requirements:** Use only with compact tractors within power range specified.

**Misuse transport:** Do not use machinery to transport personnel or livestock.

**Condition:** For the safety of personnel and optimum performance of the machine, you should check the condition of the machine and the tractor before starting. Before use check all nuts and bolts are tight.

**Spatial awareness:** Always check the operating area is safe before starting machinery.

**Operator clothing:** The operator should not wear loose clothing while operating machinery.

**Safety wear:** Always use appropriate ear protection when running a tractor and machinery. Ensure you are wearing protective gloves when servicing and using machinery.

**Bystander safety:** Ensure bystanders keep away from the machine when it is in use. Do not touch moving parts when the machine is at work.

**Public places:** When travelling on the road/public places, always keep the PTO turned off.

**Maintenance:** Always keep the machine maintained and in a good state. Where necessary, repair or replace any defective parts. Do not modify the machine.

**Sharp objects:** Pay attention to the sharp/pointed parts while servicing the machine.

**Safety guards:** All protective parts should be in good condition before operating machinery.

**Safety signs/stickers:** Keep all safety signs clean and legible. Replace any which are missing or illegible. If a component with safety sign/(s) is replaced, make sure new safety sign/(s) are attached in the same locations.

**Operating speeds:** Machinery and PTO should be operated at the recommended speed at all times.

**Safety awareness:** Good safety requires that you familiarise yourself with various safety signs, the type of warning and the area, or particular function related to that area.

**Alertness:** Never consume alcohol or drugs these can hinder alertness/coordination. Consult your doctor about using this machine while taking prescription medications.

## **General Safety Information (continued)**

### **Machinery Pre-Use Checks**

On receipt of your new Winton machine and again within the first 4 hours of use, or the 'shake in' period as we like to call it, we always recommend checking over the machine.

- Check all bolts, nuts and screws are tight on the unit.
- Tighten/check any bolts and nuts securing blades.
- If your machine has belts check the tension and adjust if required.
- Apply grease to grease points if necessary.
- Remove support/storage stands before operating machinery.
- Check oil levels and top up if needed.

### **Tractor Pre-Use Checks**

Check that the machine is properly attached to the tractor. Ensure that secure pins are used on the linkage mounting pins.

Be sure to add extra weights to the front of the tractor or add wheel weights if required.

Install and secure all safety guards, doors and covers before starting.

Bystanders should leave the immediate area before connecting the drive from the tractor.

### **Running/Operating Checks**

- Always keep the PTO output from the tractor at **540 RPM** when running machinery.
- Never use machinery at excessive speeds.

### **Post-Use Regular Checks**

Check blades, belts and wearing parts. Be sure they are not damaged and blades swing freely in their mount. Repair or replace as required.

Clean machinery and check for/clear any entangled material which may have got stuck around any rotating parts.

## Contents

	General Safety information	Pg.
		1-2
1.	Dimensions and Specifications	3
2.	Set Up & Operation	4
3.	Adjusting Ripper Tines	5
4.	Changing Blades	6
5.	Maintenance	7
6.	Parts Diagram	8
7.	Parts List	9
	Winton Product Warranty	10
	Troubleshooting	11

### 1. DIMENSIONS & SPECIFICATIONS

Model	WRB4	WRB5	WRB6
Weight	190kg	250kg	310kg
Recommended Tractor HP	16hp+	20hp+	25hp+
Working Width	120cm	150cm	180cm
Width	120cm	150cm	180cm
Depth	65cm	65cm	65cm
Height	95cm	95cm	95cm
Linkage Size	Category 1	Category 1	Category 1
Lower Linkage Width	80cm	80cm	80cm
Number Of Tines	4	5	6
Ripper Tine Working Depth	3-12cm	3-12cm	3-12cm
Number Of Scraper Blades	2 Reversible	2 Reversible	2 Reversible
Scraper Blade Steel Thickness	40mm	40mm	40mm
Steel Thickness	20mm	20mm	20mm

\*All specifications are subject to change without notice.

## 2. SET UP & OPERATION

**Safety:** Ensure tractor and machine is stopped & keys out of ignition before set-up/maintenance.

**Safety:** Check for underground wiring, pipes or other obstructions before operating.

### You will need:

Your tractor, tractor top link arm (adjustable), linkage pins and some elbow grease!

### Attaching The Machine

Start by finding a flat piece of ground. Lower the three point linkage on your tractor to its lowest position and attach the machine to the tractor using the three point linkage pins and linch pins.

Adjust the tractor's lower linkage arms up or down to ensure the machine sits level on the ground at both ends. Extend or retract the tractor's top linkage arm to get the box level so the front to back are also both touching the ground.



### Pre-Use Checklist

Before starting the machine, always check and adjust the following;

Tine height is set [Section 3]. Blades are in good condition [Section 4].

Check work site for underground obstructions. Tightness of all bolts, nuts and screws. Ensure all safety guards are in place.

### General Operating Instructions

When grading or levelling the working speed of the machine should always be at a walking pace (approx. 2 to 4 mph).

With the ripper tines raised all the way up and tractor in motion, simply lower the box scraper blade to ground level and it will start shaving the soil surface. Any dirt or aggregate material should accumulate in the box. Move the material by dragging it and then raising the scraper to deposit your load.

Alternatively, set the scraper to shave off high spots on uneven ground and the accumulated material will flow out under the blade in low spots. It can also be used for backfilling, simply lower your scraper and back the rear facing grader blade into the pile of dirt you are using for backfill.

Occasionally the ground or surface material will be very hard and will require ripping to loosen the soil to allow the scraper blade to be effective. If more aggressive ripping action is desired, lower the tines by 2" increments. If less aggressive ripping action is desired, raise all of the tines.

Getting the right set up requires experimentation and experience in your given conditions. Box scrapers generally perform better in dry to slightly damp soil conditions.



### **3. ADJUSTING RIPPER TINES**

**Safety:** Ensure tractor and machine is stopped & keys out of ignition before set-up/maintenance.

**Safety:** Always take care when handling and changing sharp blades.

Occasionally the ground or surface material will be very hard and will require ripping to loosen the soil to allow the scraper blade to be effective. If more aggressive ripping action is desired, lower the tines by 2" increments. If less aggressive ripping action is desired, raise all of the tines.

Sufficiently lift the machine so that the blades and tines can be accessed easily. Always support the machine on rigid supports and ensure it is stable before carrying out any work.

#### **Ripper Tine Height Adjustment**

1. Remove the R clip **(1)** and remove the curved pin **(2)**
2. Move the ripper tines **(3)** up or down to the desired height and align the holes on the tine and body
3. Then re-insert pin **(2)** in the slot and replace R clip **(1)**
4. Repeat the process for the remaining tines so they are all level

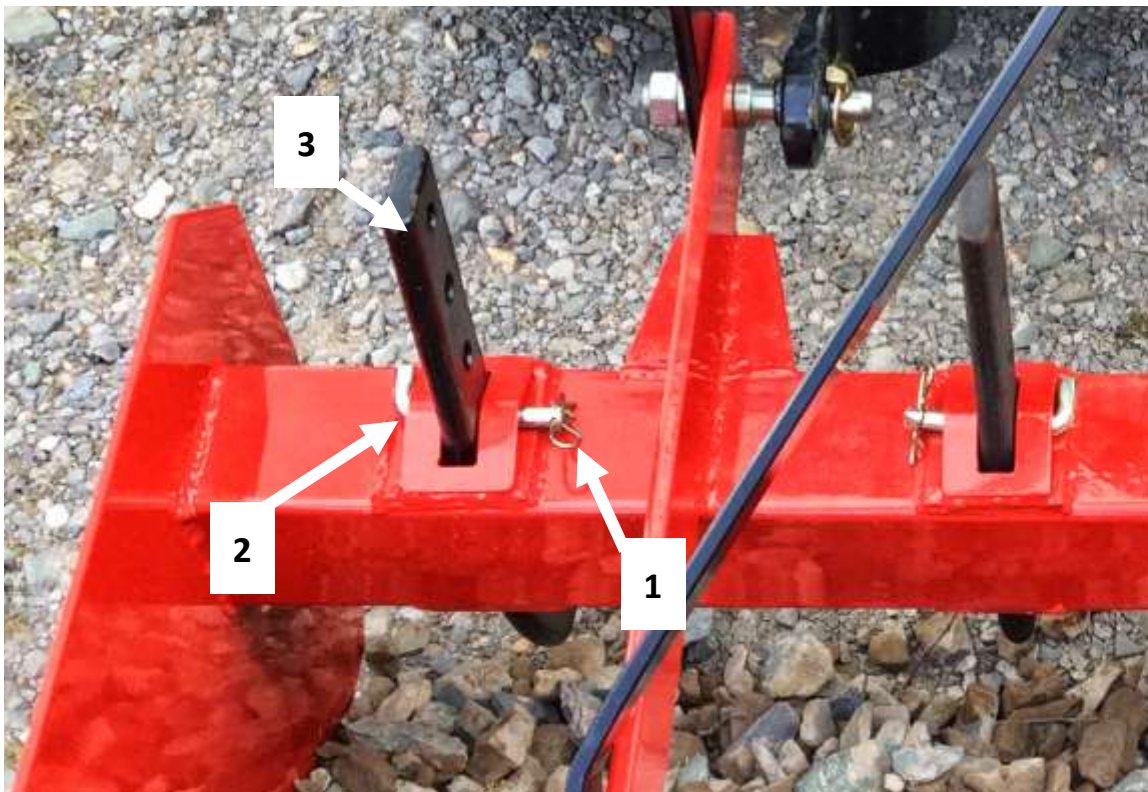

## 4. CHANGING BLADES

**Safety:** Ensure tractor and machine is stopped & keys out of ignition before set-up/maintenance.

**Safety:** Always take care when handling and changing sharp blades.

The grader blades on the inside and outside of the box are both reversible. The blade tips on the ends of the tines can also be easily removed and replaced.

Make sure to sufficiently lift the machine so that the blades and tines can be accessed easily. Always support the machine on rigid supports and ensure it is stable before carrying out any work.

### Changing Grader Blades

1. Remove all bolts **1**
2. Flip over the worn blade or replace with a new blade aligning with holes on the body
3. Replace all bolts

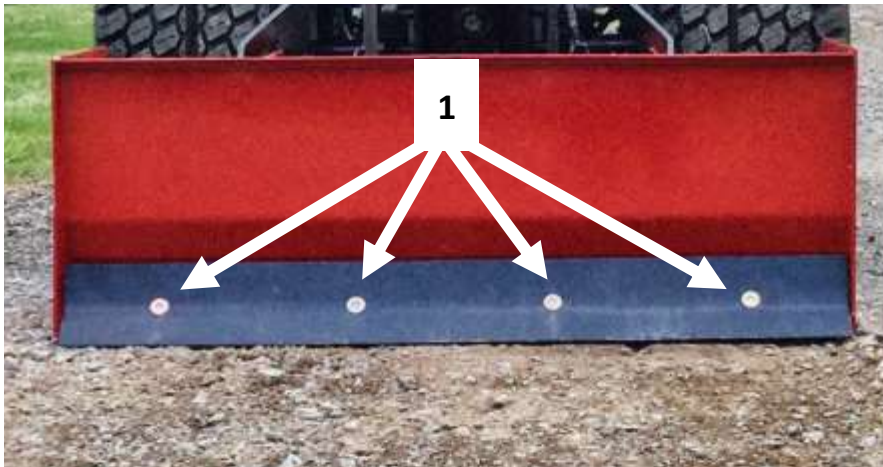

### Changing Blade Tips

1. Knock out the roll/stretch pins **2** with a punch or remove bolts and nuts if bolts are used.
2. Remove old blade tip **3** and insert the new blade.
3. Replace roll/stretch pins and knock in to place or replace bolt and nut if preferred.

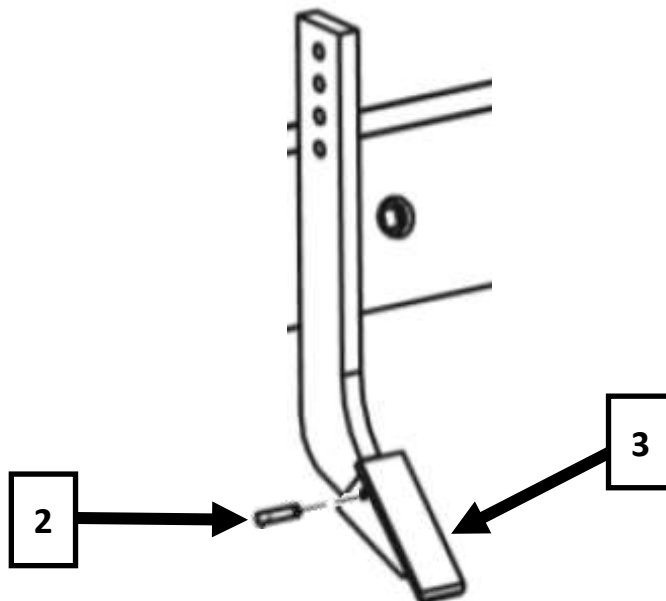



## **5. MAINTENANCE**

**Safety:** Ensure tractor and machine is stopped & keys out of ignition before set-up/maintenance.

**Safety:** Always take care when handling and changing sharp blades.

### **General Maintenance Tasks**

**Bolts:** After using your scraper for several hours, check all bolts to be sure they are tight.

**Blades:** Check blade tips before use and replace when broken or worn.

**Scraper:** Check the condition of the scraper blades. The front and rear blades have two cutting edges and are reversible. Replace the cutting blades when both edges are worn out.

**Cleaning:** Ensure the machine is cleaned of mud and grass. Remove debris is from any moving parts.

**Paintwork:** Re-coat any damaged paintwork to prevent corrosion.

**Storage:** Store the machine in a dry, level area and ensure it is stable and unable to move or overturn.

At the end of the working season or when your box scraper will not be used for long period, it is good practice to clean off any dirt or grease that may have accumulated on the scraper and any of the moving parts.

Inspect scraper for loose, damaged or worn parts and adjust or replace if needed.

\*The periods recommended are based on normal operating conditions. Severe or unusual conditions may require more frequent maintenance.

## 6. PARTS DIAGRAM

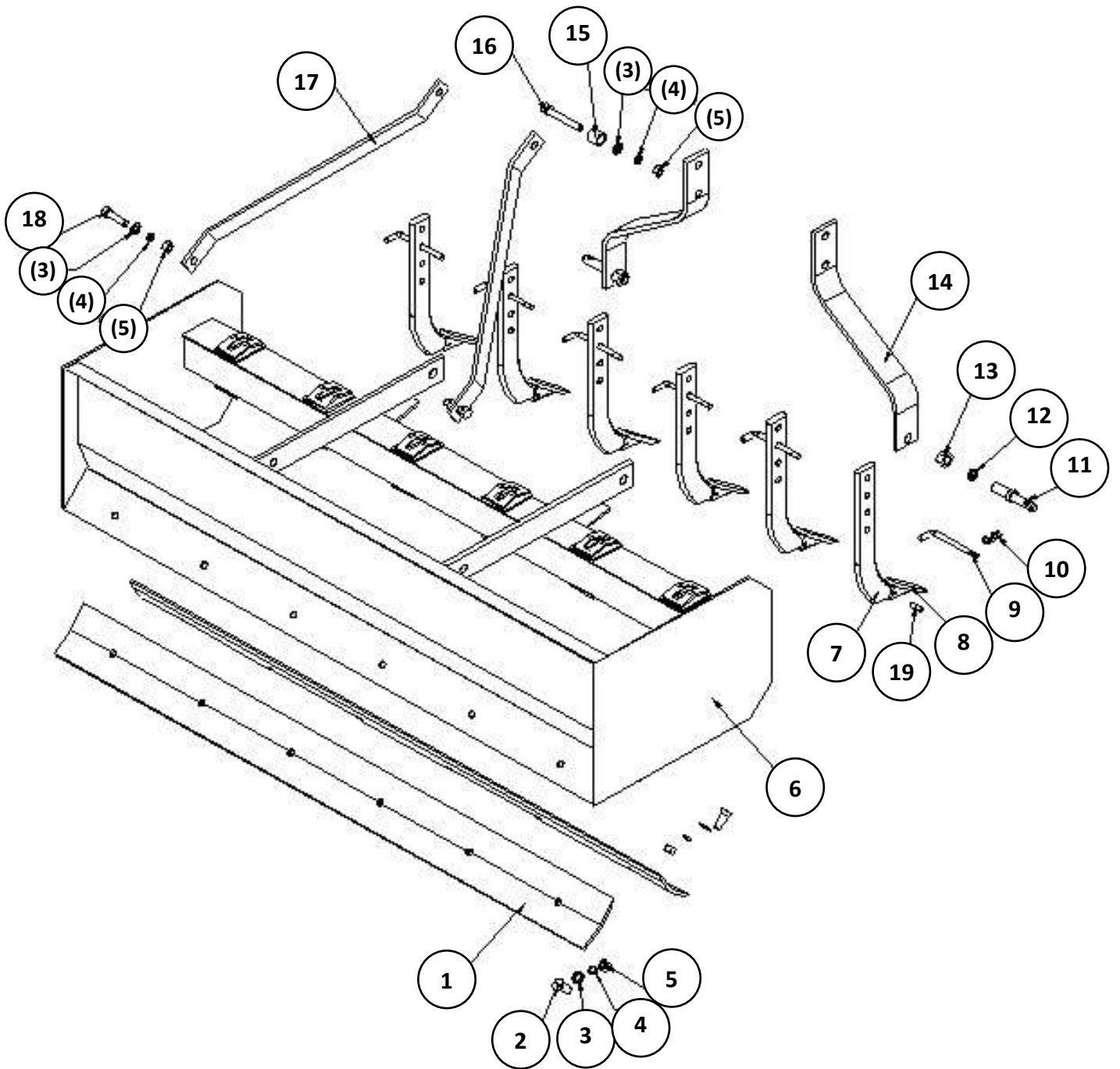

## 7. PARTS LIST

<b>Dia No.</b>	<b>Part Number</b>	<b>Part Description</b>	<b>Qty</b>
1	6GB.00.101	Grader blade 6ft	2
	5GB.00.101	Grader blade 5ft	2
	4GB.00.101	Grader blade 4ft	2
2	GB2674- M16x40	Screw M16	8/ 10/ 12
3	GB97.1-16	Plain washer M16	11/ 13/ 15
4	GB93-16	Lock washer M16	11/ 13/ 15
5	GB6170- M16	Nut M16	11/ 13/ 15
6	6BS.00.010	Main frame weldment 6ft	1
	5BS.00.010	Main frame weldment 5ft	1
	4BS.00.010	Main frame weldment 4ft	1
7	6BS.00.102	Scarifier tine	4/ 5/ 6
8	6BS.00.109	Replaceable blade tip	4/ 5/ 6
9	6BS.00.105	Pin, Lock	4/ 5/ 6
10	6BS.00.108	Clip pin	4/ 5/ 6
11	6BS.00.107	Lower linkage pin	2
12	GB93-22	Lock washer M22	2
13	GB6170- M22x1.5	Nut M22	2
14	6BS.00.103	A frame bracket	2
15	6BS.00.106	Steel collar	2
16	GB5782- M16x110	Bolt M16	1
17	6BS.00.103	Supporting bracket	2
18	GB5783- M16x50	Bolt M16	2
19	GB/T879.1-2000	Slotted spring pin 10x35	4/ 5/ 6

# WINTON PRODUCT WARRANTY

We always strive to create great products, but when something does go wrong we have a strong network of resellers on hand throughout the UK to help out.

## Warranty Claims

Before you get in touch here are 5 pieces of information your Winton reseller will need to progress your claim:

- Your invoice/order details - to include date of purchase
- Machine model number
- Machine serial number
- Details of the fault
- Images/videos of the fault

## The Terms & Conditions

All products purchased as new are covered under our 12 month warranty from the date of purchase. During this period Winton will repair or replace defective parts free of charge. This warranty is given on the proviso that the product has been used and maintained according to the Owner's Manual.

Warranty is carried out on a return to reseller / manufacturer basis and excludes any labour or delivery / collection costs.

## Exclusions

- Wearing parts are excluded; including but not limited to blades, belts and bearings.
- Modification of the product in any way will cease the manufacturers warranty.
- The machine is warranted for one year to the original purchaser, resale within the period will cease the warranty.
- Damage in transit is not covered. Claims will need to be made through the courier or your Winton reseller directly.
- Compensation for down-time, labour or loss of earnings is not covered by the warranty.
- No warranty extension will be granted for replacement parts fitted.
- Damage caused by continued use of a faulty machine will not be covered.

Your **Winton** reseller will provide their own terms and conditions upon purchase, consult this for any additional queries.

## TROUBLE SHOOTING

**Safety:** Ensure tractor and machine is stopped & keys out of ignition before set-up/maintenance.

WRB Problem	Solution
Insufficient Working Depth	<p>Lower the tines</p> <p>Reduce the working speed of tractor</p> <p>Lower the gear of the tractor if struggling with engine power</p> <p>Make several runs on harder soil, starting at a reduced depth</p> <p>Ground may be too hard, await rain fall and re-attempt</p>
Box Not Collecting	<p>Ensure the box is level left to right by adjusting the tractor's lower linkage arms</p> <p>Check box is level front to back by adjusting the tractor's top link arm length</p> <p>Ensure tractor linkage is at lowest point so the box touching the ground</p>
Tine Tips/ Blades Breaking Off	<p>Reduce the working speed of tractor</p> <p>Ground may be too hard, await rain fall and re-attempt</p> <p>Check the tine tips/blades are secured prior to starting</p>

Always consult your **Winton** dealer if you have any questions about your machine.

# NOTES







**W Winton**

[www.wintonmachinery.co.uk](http://www.wintonmachinery.co.uk)